

4

3

2

1

THESE DRAWINGS AND SPECIFICATIONS ARE THE PROPERTY OF JBL INCORPORATED. THEY ARE ISSUED IN STRICT CONFIDENCE AND SHALL NOT BE REPRODUCED OR USED AS THE BASIS FOR MANUFACTURE OR APPARATUS WITHOUT WRITTEN PERMISSION.

ALL MATERIAL SPECIFIED ON THIS DRAWING SHALL CONTINUALLY COMPLY WITH THE EFFECTIVE EU RoHS DIRECTIVE, CURRENTLY 2011/65/EU, INCLUDING ALL AMENDMENTS.

REVISIONS				
LTR	DESCRIPTION	DRFT	DATE	APPR
A	INITIAL RELEASE	KW	06/22/25	KW

D

D

C

C

B

B

A

A

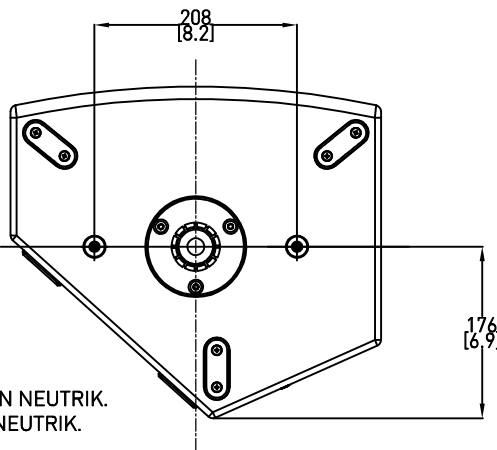
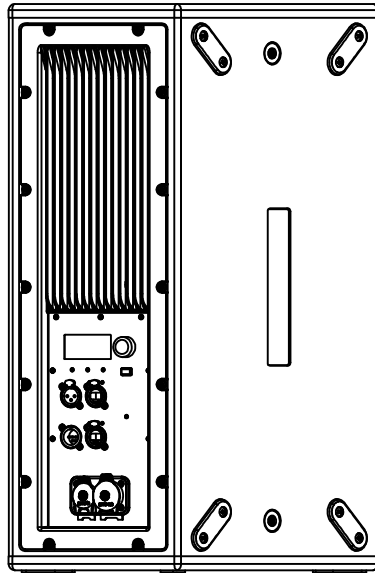
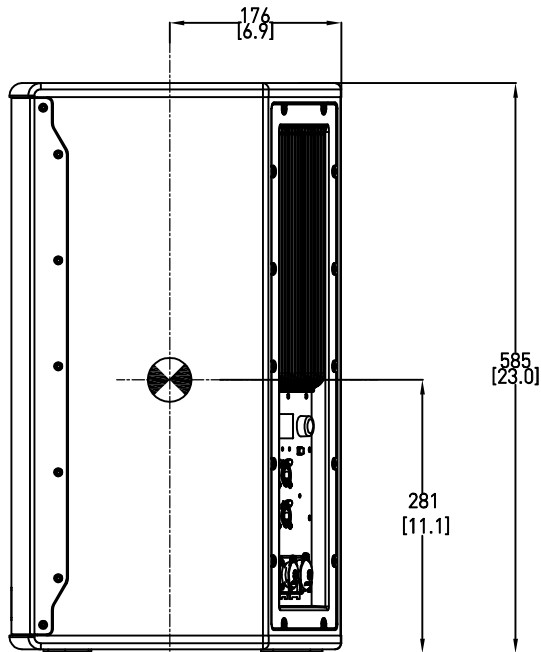
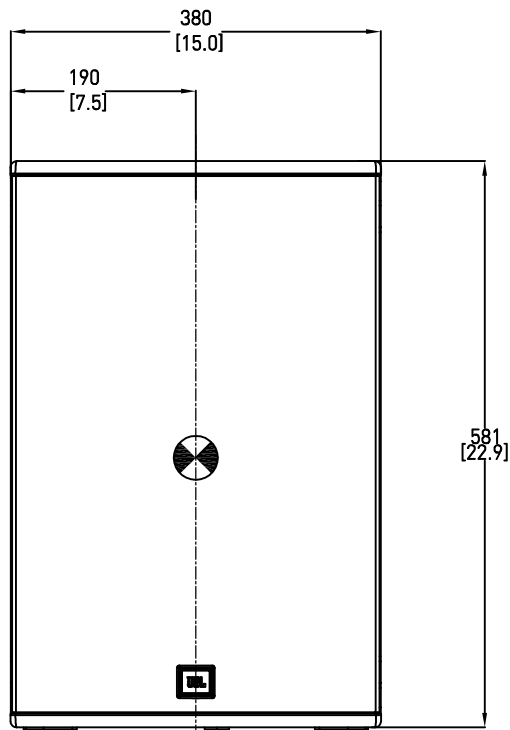
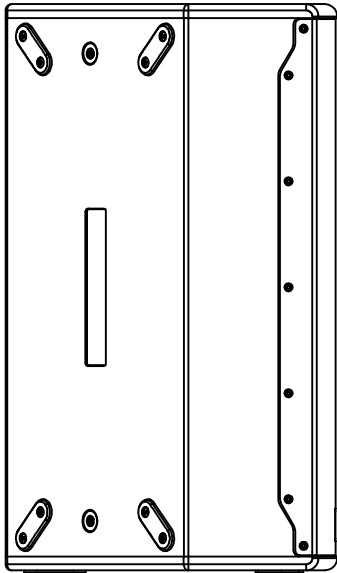
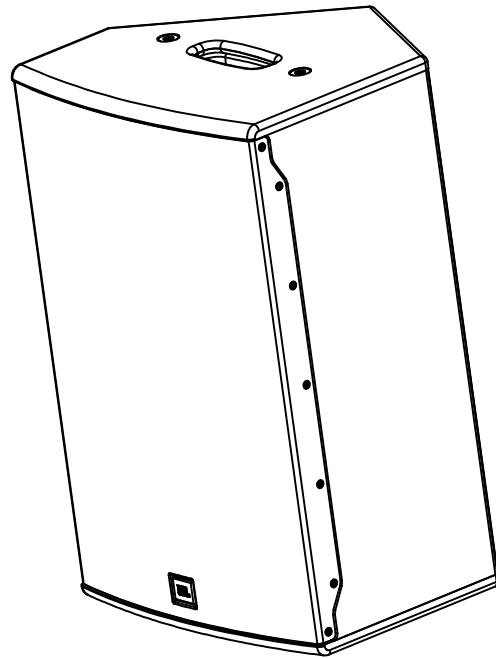
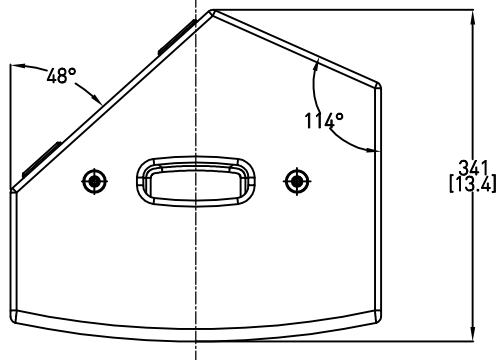

8. SYMBOL INDICATES CENTER OF GRAVITY (CG). 
7. SUSPENSION TYPE (6) M10 POINTS.
6. COMPONENTS: LF - 272F, HF - 2408H-1.
5. GRILLE MATERIAL: 16GA PERFORATED SPCC POWERCOATED BLACK AND CLOTH BACKING.
4. AUDIO INPUT CONNECTORS: (1) XLR NEUTRIK.
AUDIO THROUGH OUT CONNECTORS: (1) XLR NEUTRIK.
ETHERNET IN AND THROUGH OUT CONNECTORS: (2) ETHERCON NEUTRIK.
POWER IN AND THROUGH OUT CONNECTORS: (1) POWERCON NEUTRIK.
3. WEIGHT: 20.6 KG (45 LBS).
2. FINISH: BLACK DURAFLEX.
1. CABINET MATERIAL: 15MM EXTERIOR GRADE BIRCH PLYWOOD.

NOTES: (UNLESS OTHERWISE SPECIFIED)

TOLERANCES

(UNLESS OTHERWISE SPECIFIED)

XXX ± .063 INCH

XX ± .125 INCH

ANGULAR TOLERANCE OF 0°±30°

FRACTIONAL DIMENSIONS ± 1/32

* DIMENSIONS ARE IN MM [INCHES]

* ALL DIMENSIONS ARE FINISHED DIMENSIONS

* DO NOT SCALE DRAWING

HARMAN

JBL Professional
8500 Balboa Blvd
Northridge, CA 91329
USA

TITLE
CUSTOMER DRAWING: SRX912M

SIZE	DRAWING NO.	REV
A	1000385227	A

SCALE	SHEET	OF
NTS	1	1